



CONTROL PANELS:

- PR.45E — BRAINY HEADY p.112 p.113
- PR.45EL — BRAINY HEADY p.112 p.113
- PR.45E24 — BRAINY24 p.122

AUTOMATIONS FOR SWINGING GATES
ARTICULATED ARM

personalised release key
up to 4.0 m

ARM NOT INCLUDED



DESCRIPTION

Irreversible geared motor suitable for gates installed on large columns, available in 230 Vac and 24 Vdc versions. Built-in electromechanical open and close limit switches, with sturdy articulated anti-shearing arm in galvanised steel.

230 Vac

- Irreversible 230 Vac electromechanical geared motor also available in the PR.45EL version for large doors

24 Vdc | intensive use

- Irreversible 24 Vdc geared motor for intensive use
- Amperometric sensor obstacle detection system to prevent crushing
- Optional battery powered operation



DU.E2
9099011
Single galvanized steel arm for PR.45/PR.45EL/PR.45E24.



MB.SE
9099012
Externally fitted anti-intrusion cable unlock device which allows the gate to be unlocked from outside.



DU.V96
9765035
12 Vac/dc vertical electric lock, supplied with counterplate. Permits internal/external release.



DU.V90
9765030
12 Vac/dc horizontal electric lock, supplied with counterplate. Permits internal/external release.



DU.9990
9623010
Covering plate for DU.V90.

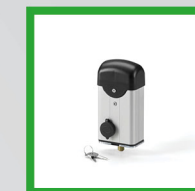

E.LOCK
9765001
230 Vac vertical electric lock, supplied with counterplate.



E.LOCKSE
9765002
Extended cylinder for E.LOCK electric lock. It allows to unlock gates up to 55mm-thick from the outside.



ID.TA
9846019
Warning board.



ESA BASIC
9176108
System that reduces the electrical energy consumption. In the 24 Vdc version, the use of ESA BASIC is not compatible with the battery operation.



KSUN
9611004
KIT for system operation via solar panel. For 24 Vdc models.

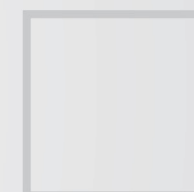
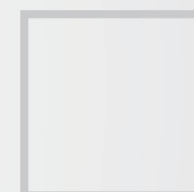
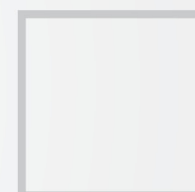
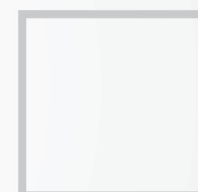
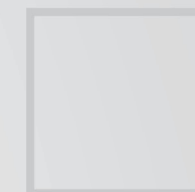
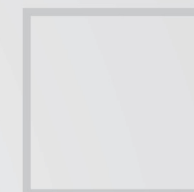

MADE IN ITALY

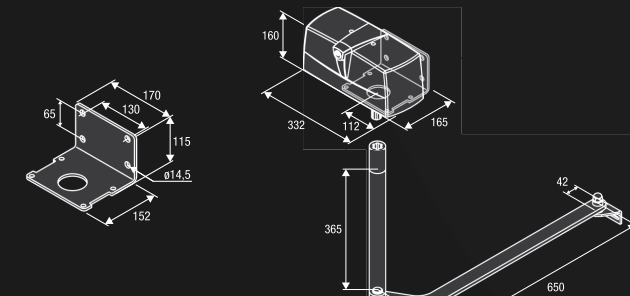

MEASURES

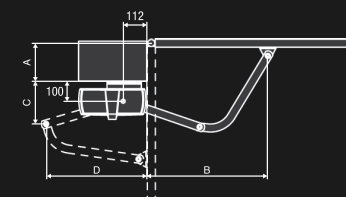

| A(mm) | B(mm) | C(mm) | D(mm) |
|-------|-------|-------|-------|
| 50 | 883 | 277 | 429 |
| 150 | 851 | 181 | 466 |
| 200 | 828 | 117 | 475 |
| 250 | 800 | 32 | 469 |
| 300 | 846 | 28 | 468 |

COMPLETE KITS

- KPR 9592073**
- 2 PR.45E 230 Vac Operators
 - 2 DU.E2 Articulated arms
 - 1 HEADY 230 Vac control unit with integrated receiver
 - 1 PUPILLA.F Pair of photocells
 - 1 LAMPI.LED 230 Vac Led flashing light with built-in aerial
 - 1 TOKEY Metal key selector
 - 1 TO.GO2WV 433.92 MHz Transmitter

- KPR.24 9592074**
- 2 PR.45E24 24 Vdc Operators
 - 1 BRAINY24 230 Vac control unit with integrated receiver
 - 2 DU.E2 Articulated arms
 - 1 PUPILLA.F Pair of photocells
 - 1 LAMPI24.LED 24 Vdc Led flashing light with built-in aerial
 - 1 TOKEY Metal key selector
 - 1 TO.GO2WV 433.92 MHz Transmitter

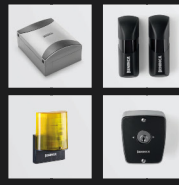

| TECHNICAL DATA | PR.45E | PR.45EL | PR.45E24 |
|-----------------------|-------------------|-------------------|-------------------|
| Code | 9590684 | 9590685 | 9590686 |
| Power supply | 230 Vac (50-60Hz) | 230 Vac (50-60Hz) | 230 Vac (50-60Hz) |
| Motor supply | 230 Vac | 230 Vac | 24 Vdc |
| Max absorbed current | 1.75 A | 1.45 A | 9 A |
| Torque | 325 Nm | 300 Nm | 320 Nm |
| Opening time | 13" | 20" | 9" |
| Operation cycle | 30% | 30% | intensive use |
| Protection level | IP44 | IP44 | IP44 |
| Operating temperature | -20°C /+50°C | -20°C /+50°C | -20°C /+50°C |
| Leaf max dimension | 3 m | 4 m | 3 m |
| Weight | 13 kg | 13 kg | 13 kg |
| Items no. per pallet | 68 | 68 | 68 |
| Kits no. per pallet | 12 | - | 12 |